

Powder Coated White Finish

Meets and/or Exceeds Current NFHS Specifications, Rules and Requirements

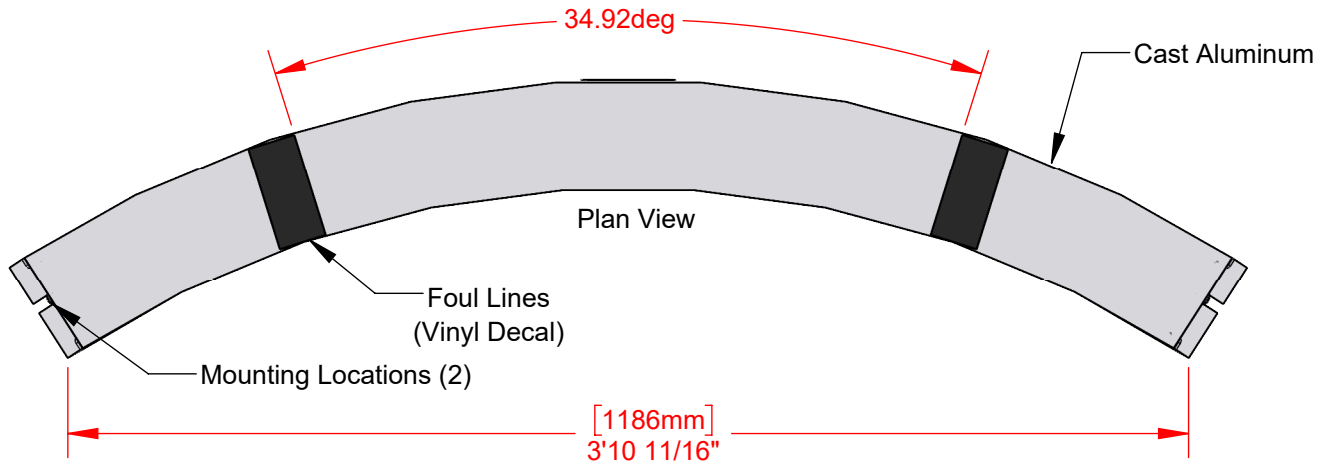

3/8"-16 x 2"L Hex Head Bolt,  
 Flat Washer, Lock Washer and  
 Two-Way Expansion Anchor  
 Hardware Included

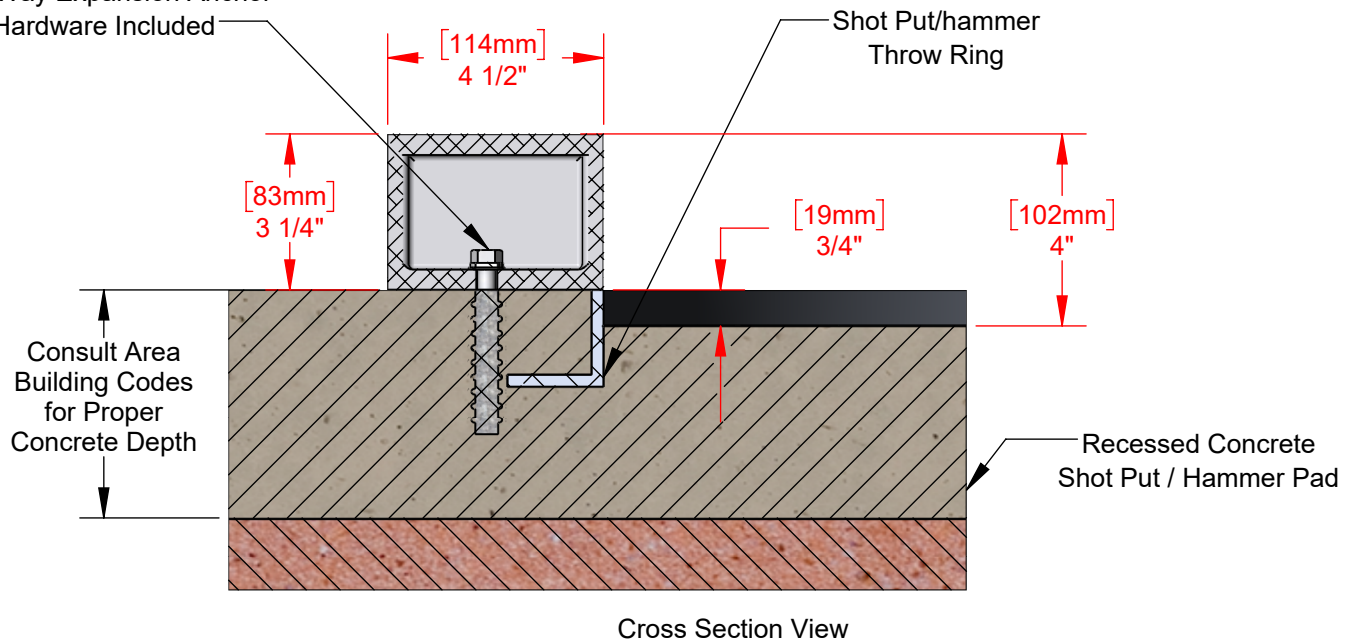

**PROPRIETARY AND CONFIDENTIAL**

THE INFORMATION CONTAINED IN THIS DRAWING IS THE SOLE PROPERTY OF SPORTSFIELD SPECIALTIES INC. ANY REPRODUCTION IN PART OR AS A WHOLE WITHOUT THE WRITTEN PERMISSION OF SPORTSFIELD SPECIALTIES INC. IS PROHIBITED.

**SPTBCARHS - High School Shot Put Toe Board Recessed Concrete Pad Installation**

Not To Scale

Sportsfield Specialties Inc 105782.1-221220