



Long / Triple Jump Pit with Ledge Covers Installation Instructions

SPCLCOL – N.C.A.A. / I.A.A.F. 3 Meter x 9 Meter

SPCLHS – High School 3 Meter x 7 Meter

United States Patent #7,641,593 – Issued January 5, 2010

Base Units

Establish the location of the sand pit per plans and specifications. Excavate a pit that is [SPCLCOL – 34' x 14', and 24" below finished grade] [SPCLHS – 28' x 14', and 24" below finishes grade]. The inside wall of the base assembly will define the sand area of the jump pit. Locate the joints and the corners of the base units and mark the sup grade with spray paint at these positions. Set concrete bricks or patio blocks at the marked locations in a bedding of stiff mortar. Bricks should be positioned so that adjacent base sections rest on a common brick. Set the top of the bricks 21" below finished grade. This is the overall height of the finished assembly. Allow the bedding mortar to set.

Pre-assemble straight base units according to the layout drawings [SPCLCOL – 2 sets of (3) 2 Meter Long Base Forms] [SPCLHS – 2 sets of (2) 2 Meter Long Base Forms] by bolting (4) ¼-20 x 1" long serrated flange hex head bolts and hex nuts. You can now hand-tighten all the nuts at this time (See Fig. A).

Pre-assemble 2 assemblies using (1) Left Hand Base Form Corner and (1) Right Hand Base Form Corner onto (1) 2 Meter Base Form by bolting (4) ¼-20 x 1" long serrated flange hex head bolts and hex nuts. You can now hand-tighten all hardware at this time.

Locate and level the side assemblies in the trench by setting the joints of the base units on the concrete bricks. The top of the outside edge of the form should be set to finished grade minus 5-1/2". Finish the assembly by bolting the corner sub-assemblies onto the straight assemblies using the remaining ¼-20 x 1" long serrated flange hex head bolts and hex nuts. You can now hand-tighten all nuts at this time.

The pit length and width is fixed by the final assembly. The assembly should now be checked for square and plumb. The inside pit length should measure [SPCLCOL – 118 1/8" x 360"] [SPCLHS – 118 1/8" x 281"]. Ascertain all measurements (square, plumb, and diagonal)

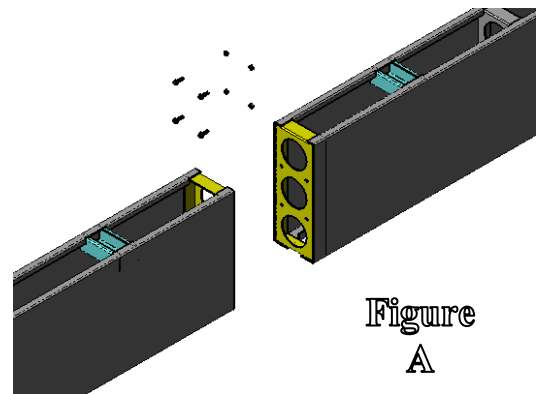

Figure
A

are correct and tighten all bolts. Correct lengths and diagonals are critical to a proper fit for the ledge cover assembly and pit covers.

Secure the location of the form by driving lengths of rebar along the inside and outside walls at several locations. Before and during concrete placement, check the pit width at several locations. Fill the forms with concrete and finish to the height of the interior braces.

IMPORTANT: Be sure to finish the concrete such that it does not go over the clamping bar cavities (See Fig. B). This must be done so that when the ledge covers are installed the steel clamping bar will engage under the lip of the clamping bar cavity. Before proceeding further, allow the concrete to set hard.

Using an appropriate fill material, backfill and compact at the outside of the base units to 12" below the top outside edge. It is advisable at this time to place the specified fill material inside the pit, i.e. drain pipe, crushed stone, filter fabric, pit sand, etc. This will help to further stabilize the base unit against movement.

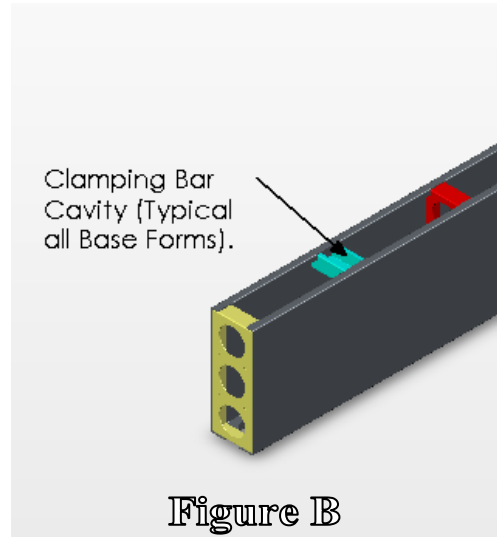

Ledge Covers

Prior to installing the ledge covers onto the base forms, thread 5/16-18 x 1 1/2" long stainless steel hex head bolts, washers, lock washers and steel threaded flat bar onto all sand catcher components. There are (2) locations per sand catcher component easily identified by obround-shaped holes. Thread steel flat bar onto bolt until bolt is flush with flat surface of flat bar. Position all flat bars on all components as shown in Figure C.

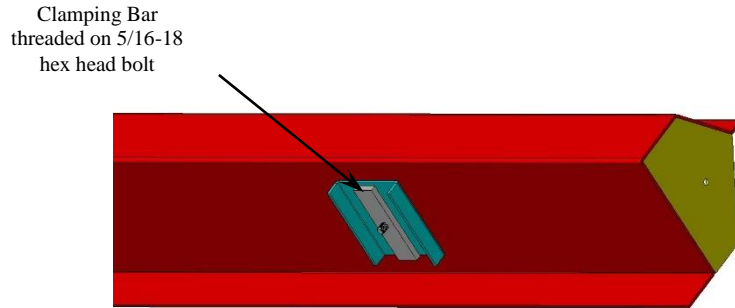

Figure C

Once this has been accomplished, begin the installation process with the corner ledge covers. Place the ledge covers onto the base forms but do not tighten the bolts at this time. Next, install

the ledge cover with the runway insert, then the ledge cover without the runway insert. Finish by installing the remaining ledge covers. Prior to tightening the bolts, align all ledge covers.

Install ¼-20 x 1" long serrated flange hex head bolts and hex nuts onto the ledge cover ends located on all ledge cover components (See Fig. D). At this time, make one final check and be certain all components are correctly aligned, plumbed, and squared. It is critical that the components are aligned correctly so as the sand pit covers will fit properly after final installation.

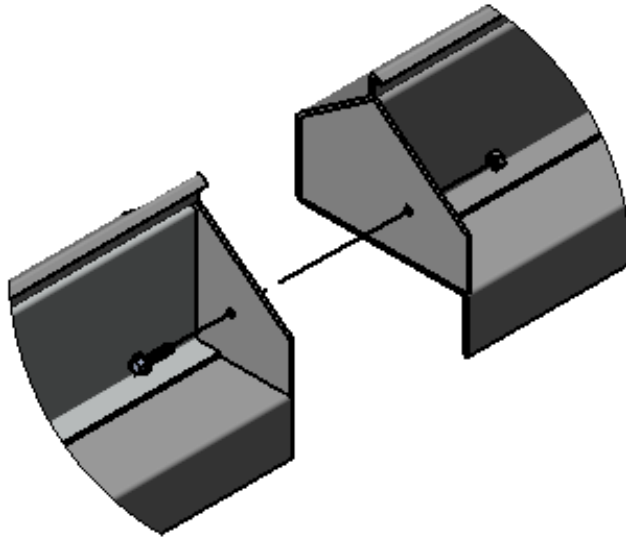
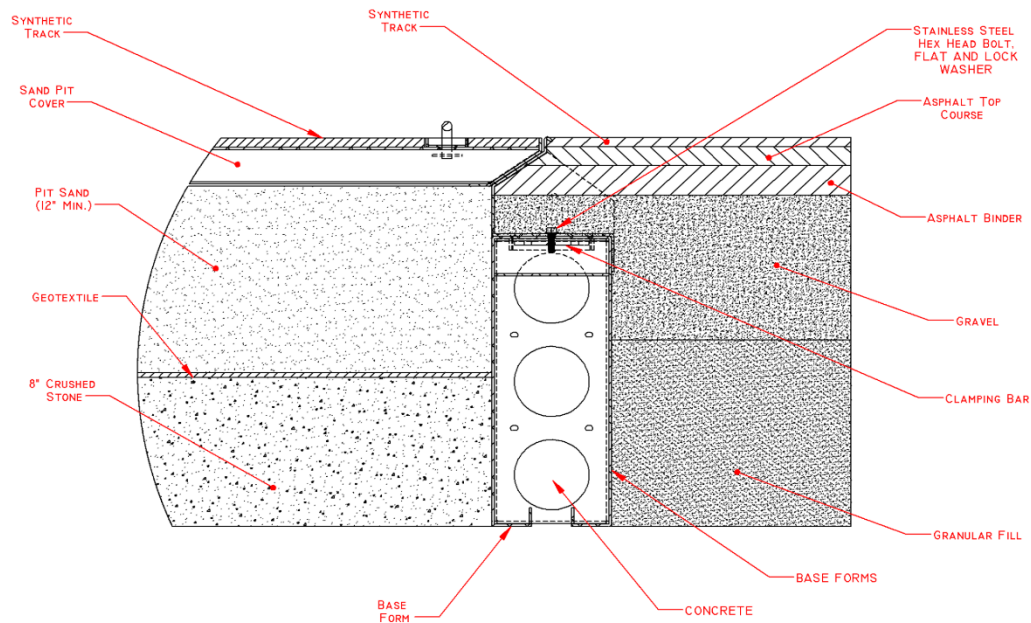

Figure D

Tighten all 5/16-18 bolts. Tighten all ¼-20 bolts. Back fill with appropriate material. See Figure E for recommended requirements on top surface material.



**Sectional View of
SPCLCOL/SPCLHS Sand Pit
with Ledge Covers**

Figure E

Covers

Pit covers are made to fit into an opening that is exactly 3 meters (118 1/8") wide and [SPCLCOL – 9.14 m (360") long] [SPCLHS – 7.14m (281") long]. A small tolerance is built into the cover design to allow for easy removal and replacement under various climatic conditions.

The 13mm (1/2") recess in the cover panels is to be filled with rubber track material by the track contractor. Be careful to mask the lift handle pockets prior to filling the covers. **NOTE: Long/Triple Jump Pit Panel Covers are designed to be removed and/or repositioned by two people. Please do not attempt to handle pit covers in any other manner as this may result in damage to the Long/Triple Jump Pit or Pit Covers and/or result in personal injury.**

REPLACEMENT PARTS

Contact Sportsfield Specialties Customer Service at 1-888-975-3343 for replacement hardware.



Sportsfield Specialties, Inc.
P.O. Box 231
41155 State Highway 10
Delhi, N.Y. 13753
Phone: 888-975-3343
Fax: 607-746-8911
www.sportsfieldspecialties.com

FRACTION	DECIMAL	METRIC
1/64	.0156	3.969
1/32	.0313	7.938
3/64	.0469	11.906
1/16	.0625	15.875
5/64	.0781	19.844
3/32	.0938	23.813
7/64	.1094	27.781
9/64	.1406	35.719
5/32	.1563	39.688
11/64	.1719	43.656
3/16	.1875	47.625
13/64	.2031	51.594
7/32	.2188	55.563
15/64	.2344	59.531
1/4	.2500	63.500
17/64	.2656	67.469
9/32	.2813	71.438
19/64	.2969	75.406
5/16	.3125	79.375
21/64	.3281	83.344
11/32	.3438	87.313
23/64	.3594	91.281
3/8	.3750	95.250
25/64	.3906	99.219
13/32	.4063	103.188
27/64	.4219	107.156
7/16	.4375	111.125
29/64	.4531	115.094
15/32	.4688	119.063
31/64	.4844	123.031
1/2	.5000	127.000
33/64	.5156	130.969
17/32	.5313	134.938
35/64	.5469	138.906
9/16	.5625	142.875
37/64	.5781	146.844
19/32	.5938	150.813
39/64	.6094	154.781
5/8	.6250	158.750
41/64	.6406	162.719
21/32	.6563	166.688
43/64	.6719	170.656
11/16	.6875	174.625
45/64	.7031	178.594
23/32	.7188	182.563
47/64	.7344	186.531
3/4	.7500	190.500
49/64	.7656	194.469
25/32	.7813	198.438
51/64	.7969	202.406
13/16	.8125	206.375
53/64	.8281	210.344
27/32	.8438	214.313
55/64	.8594	218.281
7/8	.8750	222.250
57/64	.8906	226.219
59/64	.9063	230.188
15/16	.9219	234.156
61/64	.9375	238.125
31/32	.9531	242.094
63/64	.9688	246.063
65/64	.9844	250.031

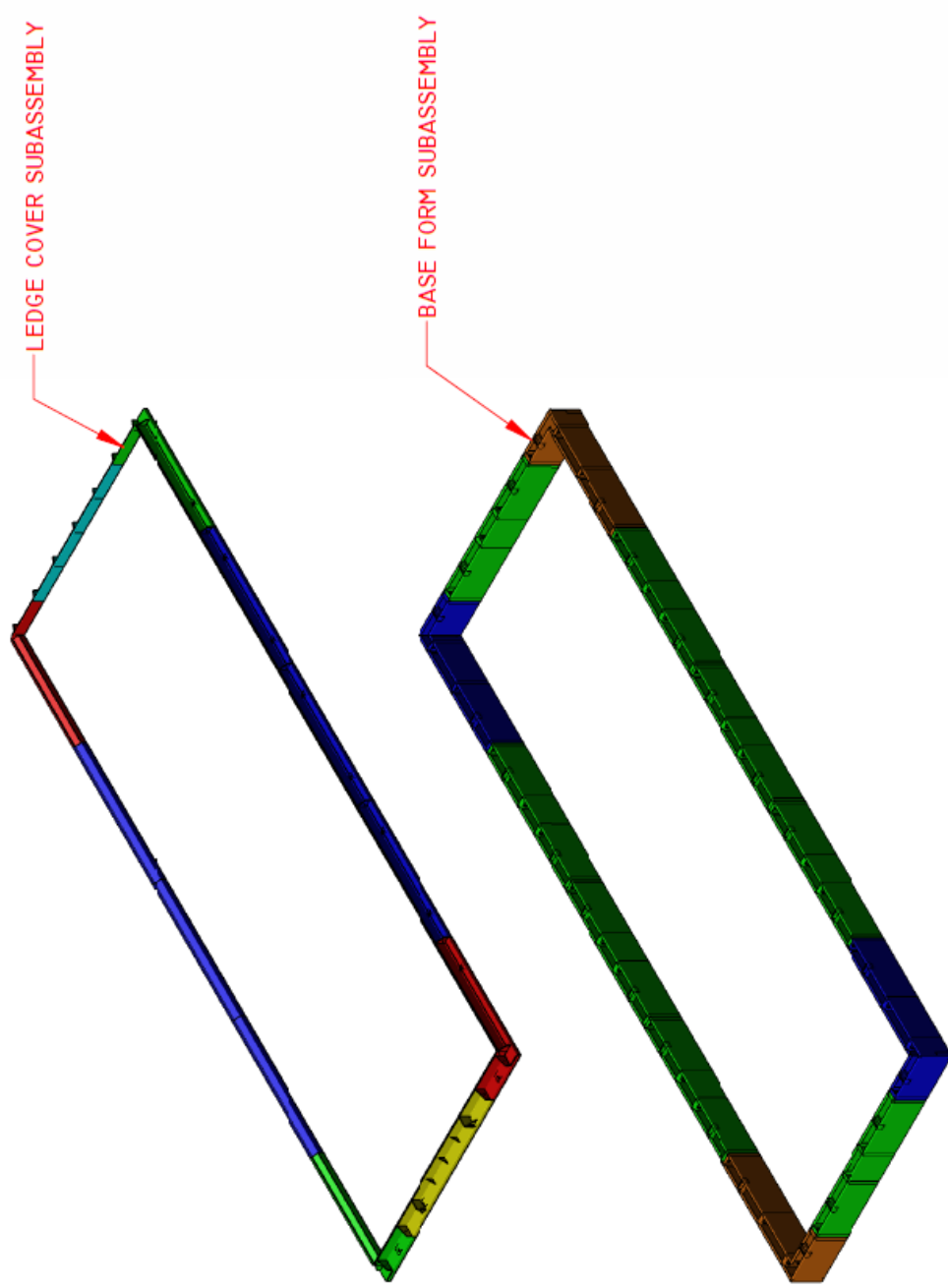

<p>ERP Part No. SPLCOL</p>		<p>TITLE: JumpForm® NCAA 3m x 9m Sand Pit with Cover Ledges Final Assembly</p>
<p>NAME</p>	<p>DATE 11/25/2015</p>	<p>SIZE A</p>
<p>DRAWN</p>	<p>CHECKED</p>	<p>DWG. NO. SP6012 (A SIZE)</p>
<p>ENG. APPR.</p>	<p>REVISION DATE</p>	<p>REV</p>
<p>UNLESS OTHERWISE SPECIFIED: DIMENSIONS ARE IN INCHES TOLERANCES: FRACTIONAL: 1/16 ANGULAR: MACH: ± BEND ± TWO PLACE DECIMAL ± .01 THREE PLACE DECIMAL ±.005</p>		<p>SCALE: 1:72 WEIGHT: 552.728 SHEET 1 OF 3</p>
<p>INTERPRET GEOMETRIC TOLERANCING PER:</p>		<p>APPLICATION DO NOT SCALE DRAWING</p>
<p>MATERIAL</p>	<p>FINISH None</p>	<p>USED ON</p>
<p>NEXT ASSY</p>	<p>APPLICATION</p>	<p>DO NOT SCALE DRAWING</p>

PROPRIETARY AND CONFIDENTIAL
This drawing is the confidential property of Sportfield Specialties, Inc. and is to be used only by authorized personnel and in the interest of Sportfield Specialties, Inc. No part of this drawing may be reproduced, stored in a retrieval system, or transmitted in any form or by any means, electronic, mechanical, photocopying, recording, or by any information storage and retrieval system, without the prior written permission from Sportfield Specialties, Inc. and must be returned to Sportfield Specialties, Inc. if stolen or any time upon request, but in any event of this (the) employees to keep confidential the information contained here on. Disclosure of the information for any other purpose without the prior written permission of Sportfield Specialties, Inc. is prohibited.
Sportfield Specialties, Inc. Dept. N.Y.

ITEM NO.	BASE FORM ASSEMBLY/QTY.	DESCRIPTION	WEIGHT	ERP PART NUMBER
1	8	2M BASE FORM	44.168	E-0020-S001
2	2	BASE FORM CORNER, R.H.	49.501	E-0020-S005
3	2	BASE FORM CORNER, L.H.	49.456	E-0020-S002
4	48	1/4-20 x 1" HEX WASHER HEAD WITH SERRATED FLANGE, GRADE 5, FULLY THREADED	0.022	100-HWH-0001
5	48	1/4-20 STAINLESS STEEL HEX NUT	0.008	107-HXN-0010

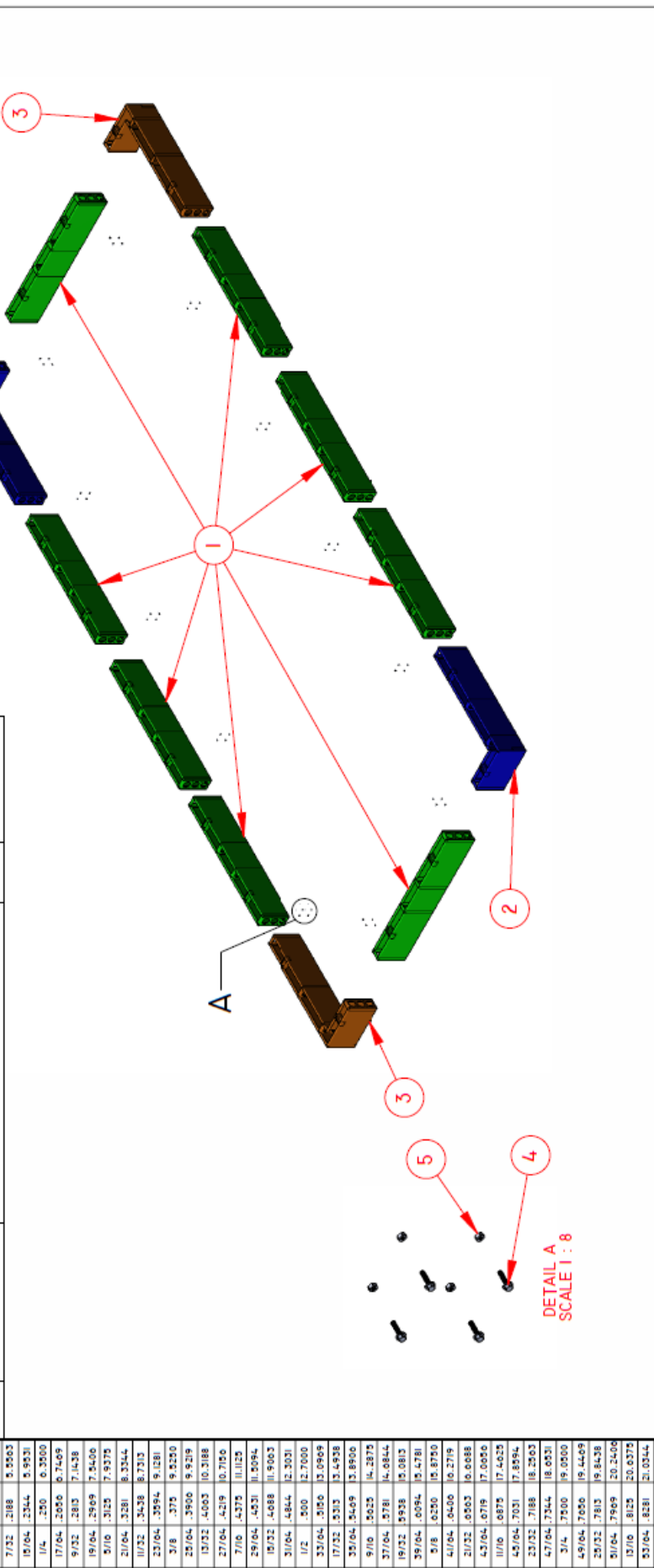

NAME	DATE	ERP Part No. SPLCOL	
DRAWN	III/25/2015	TITLE: JumpForm® NCA 3m x 9m Sand Pit with Cover Ledges Base Form Sub-Assembly	
CHECKED		SIZE DWG. NO. REV A SP6012 (A SIZE)	
ENG APPR.		SCALE: 1:70 WEIGHT: 552.728 SHEET 2 OF 3	
UNLESS OTHERWISE SPECIFIED:			
DIMENSIONS ARE IN INCHES			
TOLERANCES:			
FRACTIONAL: 1/16			
ANGULAR: MACH: BEND ±			
TWO PLACE DECIMAL ±.01			
THREE PLACE DECIMAL ±.005			
INTERPRET GEOMETRIC TOLERANCING PER:			
MATERIAL			
FINISH			
USED ON			
APPLICATION			
DO NOT SCALE DRAWING			
NEXT ASSY			
Revision Date			
None			

PROPRIETARY AND CONFIDENTIAL

This drawing is the confidential property of Specialties, Inc. and is to be used only by authorized personnel and in the interest of Specialties, Inc. No part of this drawing may be reproduced, stored in a retrieval system, or transmitted in any form or by any means, electronic, mechanical, photocopying, recording, or by any information storage and retrieval system, without the prior written permission from Specialties, Inc. and must be returned to Specialties, Inc. if stated at any time upon request, but in any event of this drawing is to be used for any purpose other than that for which it was prepared, the user shall be responsible for obtaining the necessary rights from the appropriate owner. Disclosure of the information contained herein shall be made only to those persons who require such information in connection with approved Specialties, Inc. projects.

Specialties, Inc. Delix, N.Y.

ITEM NO.	LEDGE COVER ASSEMBLY /QTY.	DESCRIPTION	WEIGHT	ERP/PART NUMBER
1	24	CLAMPING BAR	0.190	E-0020-0001
2	24	5/16 S.S. FLAT WASHER	0.008	I10-FLW-0007
3	24	5/16 S.S. LOCK WASHER	0.004	I10-SLW-0007
4	24	5/16-18 x 1.5" HEX HEAD BOLT, 304 SS	0.0413	101-HHC-0047
5	2	COVER LEDGE, L.H. CORNER	20.533	E-0020-S015
6	2	COVER LEDGE, R.H. CORNER	15.692	E-0020-S016
7	1	RUNWAY INSERT, LEDGE COVER	14.789	
8	6	COVER LEDGE, 2 METERS	20.163	E-0020-S013
9	1	COVER LEDGE, 2 METER (NO RUNWAY INSERT)	14.506	E-0020-S014
10	12	1/4-20 x 1" HEX WASHER HEAD WITH SERRATED FLANGE, GRADE 5, FULLY THREADED	0.022	100-HWH-0001
11	12	1/4-20 STAINLESS STEEL HEX NUT	0.008	107-HXN-0010

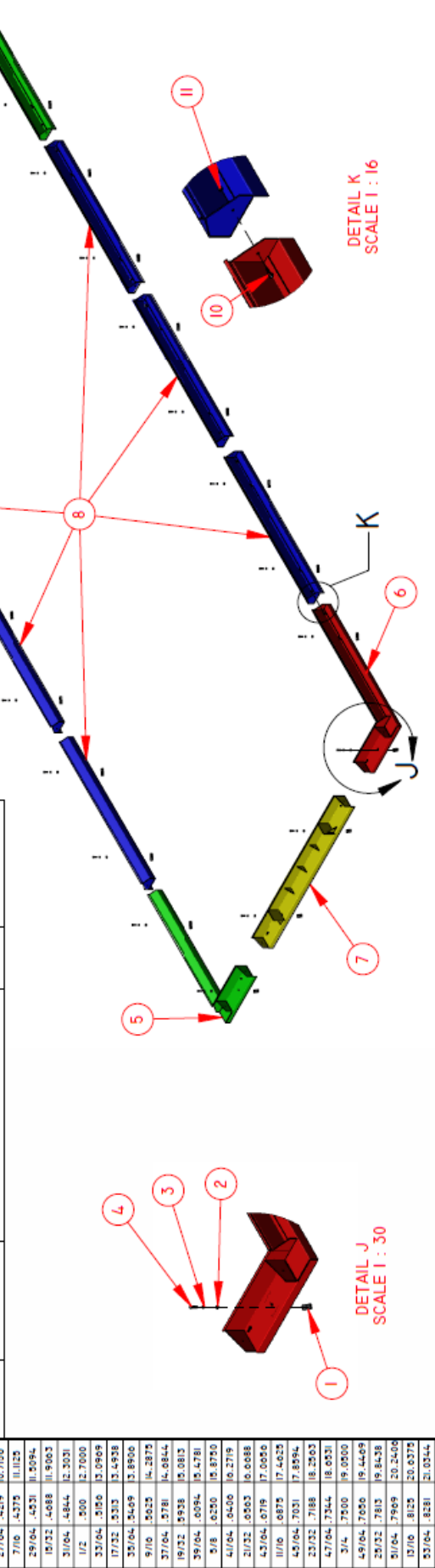

ERP Part No. SPLCOL	
TITLE: JumpForm® NCAA 3m x 9m Sand Pit with Cover Ledges Ledge Cover Sub-Assembly	DATE: 11/25/2015
DRAWN: [Blank]	CHECKED: [Blank]
ENG APPR.: [Blank]	REVISION DATE: [Blank]
UNLESS OTHERWISE SPECIFIED: DIMENSIONS ARE IN INCHES TOLERANCES: FRACTIONAL: 1/16 ANGULAR: MACH: BND ± TWO PLACE DECIMAL ±.01 THREE PLACE DECIMAL ±.005 INTERPRET GEOMETRIC TOLERANCING PER: [Blank]	SIZE DWG. NO.: A SP6012 (A SIZE)
MATERIAL: [Blank]	REV: [Blank]
FINISH: None	SCALE: 1:96 WEIGHT: 228.925
APPLICATION: DO NOT SCALE DRAWING	SHEET: 3 OF 3

PROPRIETARY AND CONFIDENTIAL
 This drawing is the confidential property of Spotted Speculatives, Inc. and is to be used only by authorized personnel and in the interest of Spotted Speculatives, Inc. No part of this drawing may be reproduced, stored in a retrieval system, or transmitted in any form or by any means, electronic, mechanical, photocopying, recording, or by any information storage and retrieval system, without the prior written permission from Spotted Speculatives, Inc. and must be returned to Spotted Speculatives, Inc. as stated at any time upon request, but in any event at the end of the project. Spotted Speculatives, Inc. reserves the right to change the information contained herein without notice. The information contained herein shall be made only to those persons who require such information for the specific project.
 Spotted Speculatives, Inc. Delhi, N.Y.

FRACTION	DECIMAL	METRIC
1/64	.0156	3.969
1/32	.0313	7.938
3/64	.0469	11.906
1/16	.0625	15.875
5/64	.0781	19.844
3/32	.0938	23.813
7/64	.1094	27.781
1/8	.125	31.750
9/64	.1406	35.719
5/32	.1563	39.688
11/64	.1719	43.656
3/16	.1875	47.625
13/64	.2031	51.594
7/32	.2188	55.563
15/64	.2344	59.531
1/4	.2500	63.500
17/64	.2656	67.469
9/32	.2813	71.438
19/64	.2969	75.406
5/16	.3125	79.375
21/64	.3281	83.344
11/32	.3438	87.313
23/64	.3594	91.281
3/8	.3750	95.250
25/64	.3906	99.219
13/32	.4063	103.188
27/64	.4219	107.156
7/16	.4375	111.125
29/64	.4531	115.094
15/32	.4688	119.063
31/64	.4844	123.031
1/2	.5000	127.000
33/64	.5156	130.969
17/32	.5313	134.938
35/64	.5469	138.906
9/16	.5625	142.875
37/64	.5781	146.844
19/32	.5938	150.813
39/64	.6094	154.781
5/8	.6250	158.750
41/64	.6406	162.719
21/32	.6563	166.688
43/64	.6719	170.656
11/16	.6875	174.625
45/64	.7031	178.594
23/32	.7188	182.563
47/64	.7344	186.531
3/4	.7500	190.500
49/64	.7656	194.469
25/32	.7813	198.438
51/64	.7969	202.406
13/16	.8125	206.375
53/64	.8281	210.344
27/32	.8438	214.313
55/64	.8594	218.281
7/8	.8750	222.250
57/64	.8906	226.219
59/32	.9063	230.188
59/64	.9219	234.156
15/16	.9375	238.125
61/64	.9531	242.094
31/32	.9688	246.063
63/64	.9844	250.031

COVER LEDGE SUBASSEMBLY

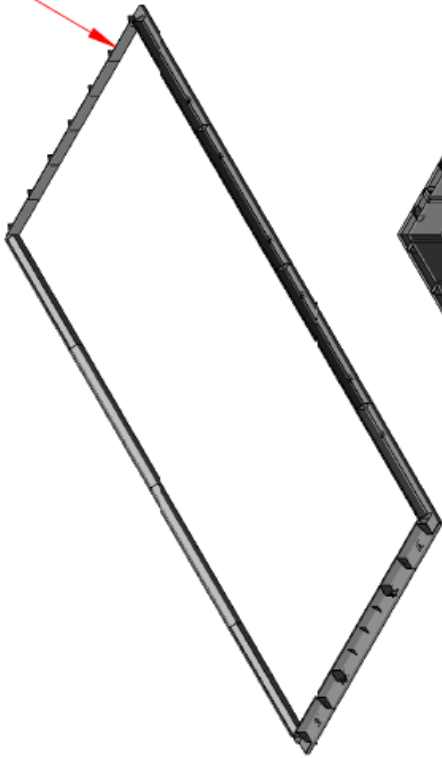

BASE FORM SUBASSEMBLY

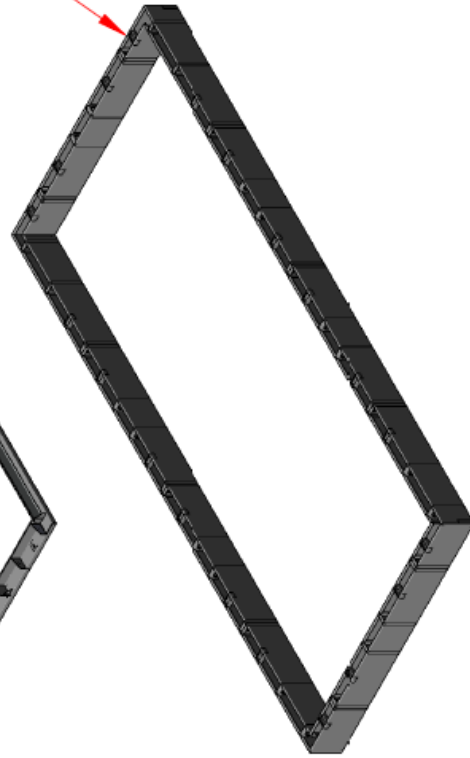

ERP Part No.

SPLCHS

TITLE:
JumpForm® High School 3m x 7m
Sand Pit with Cover Ledges
Final Assembly

NAME	DATE
	11/25/2015

DRAWN
CHECKED
ENG. APPR.

UNLESS OTHERWISE SPECIFIED:
DIMENSIONS ARE IN INCHES
TOLERANCES:
FRACTIONAL: 1/16
ANGULAR: MACH: BEND ±
TWO PLACE DECIMAL ±.01
THREE PLACE DECIMAL ±.005
INTERPRET GEOMETRIC
TOLERANCING PER:
MATERIAL
FINISH
None
USED ON
APPLICATION

SIZE DWG. NO.
A SP6022 (A SIZE)
REV

SCALE: 1:72 WEIGHT: 464.147 SHEET 1 OF 3

DO NOT SCALE DRAWING

PROPRIETARY AND CONFIDENTIAL
This drawing is the confidential property of Spofthead Specialties, Inc. and is to be used only by authorized personnel and in the interest of Spofthead Specialties, Inc. It is not to be reproduced, copied, or transmitted in any form or by any means, electronic or mechanical, including photocopying, recording, or by any information storage and retrieval system, without the prior written permission from Spofthead Specialties, Inc. and must be returned to Spofthead Specialties, Inc. if stolen or any time upon request, but in any event of disclosure of this information to any third party, the user shall be held responsible for the full (10) employees to keep confidential the information contained here on. Disclosure of this information to any third party without the prior written permission of Spofthead Specialties, Inc. projects.
Spofthead Specialties, Inc. Delhi, N.Y.

FRACTION	DECIMAL	METRIC
1/64	.0156	3.9625
1/32	.0313	7.9375
3/64	.0469	11.9125
1/16	.0625	15.875
5/64	.0781	19.844
3/32	.0938	23.813
7/64	.1094	27.778
1/8	.125	31.75
9/64	.1406	35.719
5/32	.1563	39.688
11/64	.1719	43.656
3/16	.1875	47.625
13/64	.2031	51.594
7/32	.2188	55.563
15/64	.2344	59.531
1/4	.25	63.5
17/64	.2656	67.469
9/32	.2813	71.437
19/64	.2969	75.406
5/16	.3125	79.375
21/64	.3281	83.344
11/32	.3438	87.313
23/64	.3594	91.281
3/8	.375	95.25
25/64	.3906	99.219
13/32	.4063	103.188
27/64	.4219	107.156
7/16	.4375	111.125
29/64	.4531	115.094
15/32	.4688	119.063
31/64	.4844	123.031
1/2	.5	127.0
33/64	.5156	130.969
17/32	.5313	134.938
35/64	.5469	138.906
9/16	.5625	142.875
19/32	.5781	146.844
19/32	.5938	150.813
39/64	.6094	154.781
5/8	.625	158.75
41/64	.6406	162.719
21/32	.6563	166.688
43/64	.6719	170.656
11/16	.6875	174.625
23/32	.7188	182.594
47/64	.7344	186.563
3/4	.75	190.531
49/64	.7656	194.5
25/32	.7813	198.469
51/64	.7969	202.437
13/16	.8125	206.406
53/64	.8281	210.375
27/32	.8438	214.344
55/64	.8594	218.313
7/8	.875	222.281
57/64	.8906	226.25
29/32	.9063	230.219
59/64	.9219	234.188
15/16	.9375	238.156
61/64	.9531	242.125
31/32	.9688	246.094
63/64	.9844	250.063

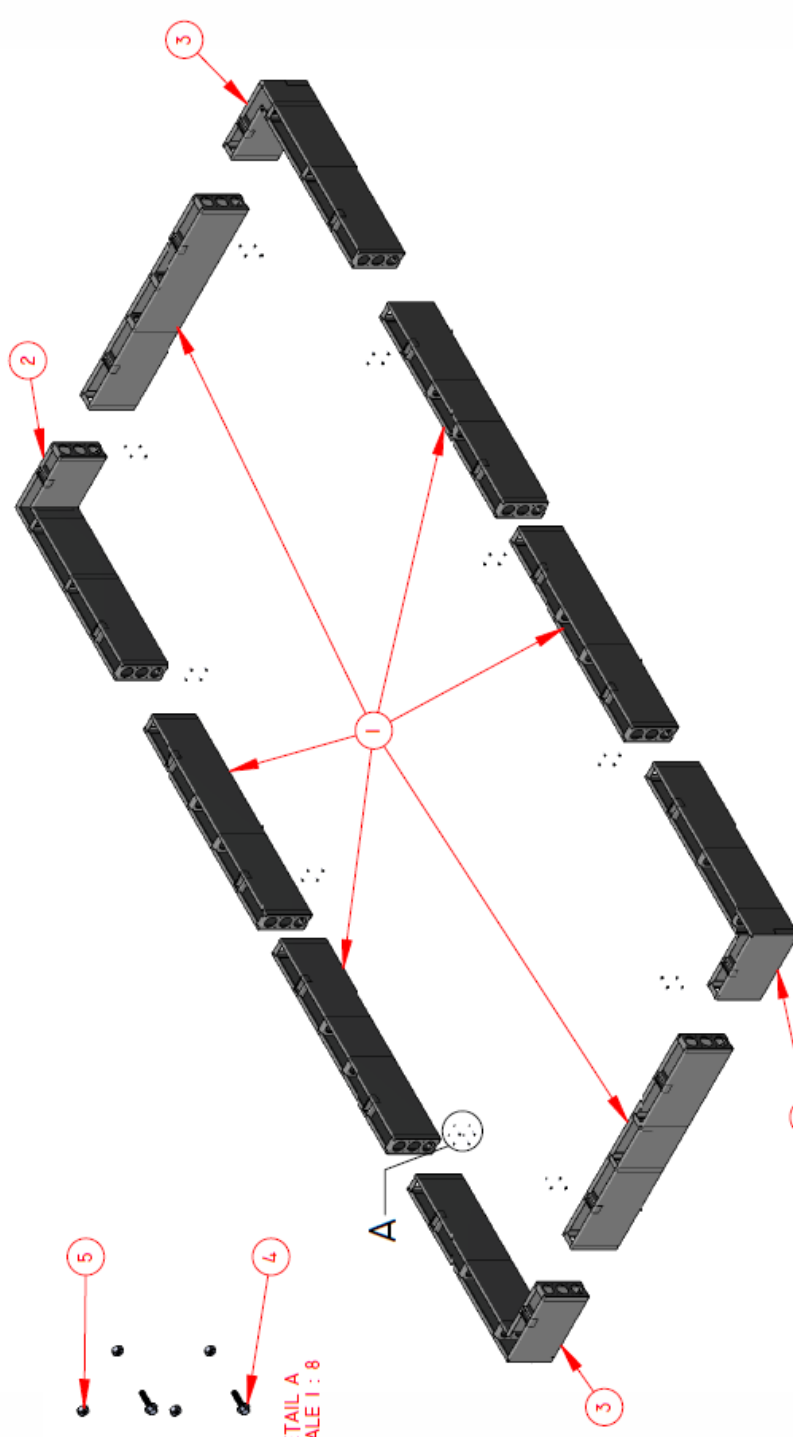

ITEM NO.	BASE FORM ASSEMBLY/QTY.	DESCRIPTION	WEIGHT	ERP PART NUMBER
1	6	2M BASE FORM	44.168	E-0020-S001
2	2	BASE FORM CORNER, R.H.	49.501	E-0020-S005
3	2	BASE FORM CORNER, L.H.	49.456	E-0020-S002
4	40	1/4-20 x 1" HEX WASHER HEAD WITH SERRATED FLANGE, GRADE 5, FULLY THREADED	0.022	100-HWH-0001
5	40	1/4-20 STAINLESS STEEL HEX NUT	0.008	107-HXN-0010

ERP Part No. SPLCHS	
TITLE: JumpForm® High School 3m x 7m Sand Pit with Cover Ledges Base Form Sub-Assembly	SIZE DWG. NO. A SP6022 (A SIZE)
REVISIONS: DRAWN: _____ DATE: 11/25/2015 CHECKED: _____ ENG. APPR.: _____	REV _____
UNLESS OTHERWISE SPECIFIED: DIMENSIONS ARE IN INCHES TOLERANCES: FRACTIONAL: 1/16 ANGULAR: MACH: ± .01 TWO PLACE DECIMAL: ± .01 THREE PLACE DECIMAL: ± .005 INTERPRET GEOMETRIC TOLERANCING PER: _____ MATERIAL: _____	FINISH None
APPLICATION DO NOT SCALE DRAWING	SCALE: 1:70 WEIGHT: 464.147 SHEET 2 OF 3

PROPRIETARY AND CONFIDENTIAL
 This drawing is the confidential property of Spofthead Specialties, Inc. and is to be used only by authorized personnel and in the interest of Spofthead Specialties, Inc. It is not to be reproduced, copied, or transmitted in any form without the prior written permission from Spofthead Specialties, Inc. and must be returned to Spofthead Specialties, Inc. in whole or in part upon request. In any event, the information contained herein is confidential and its disclosure to any third party (including employees) without the prior written permission of Spofthead Specialties, Inc. is prohibited. Spofthead Specialties, Inc. reserves the right to modify this information without notice. Disclosure of this information to any third party without the prior written permission of Spofthead Specialties, Inc. is prohibited.
 Spofthead Specialties, Inc. Delix, N.Y.

FRACTION	DECIMAL	METRIC
1/64	0.0156	3.969
1/32	0.0313	7.938
3/64	0.0469	11.907
1/16	0.0625	15.875
5/64	0.0781	19.844
3/32	0.0938	23.813
1/8	0.125	31.750
7/64	0.1094	27.778
5/32	0.1563	39.688
3/16	0.1875	47.625
13/64	0.2031	51.654
7/32	0.2188	55.683
5/16	0.3125	79.375
3/8	0.375	95.250
1/2	0.500	127.000
5/8	0.625	158.750
3/4	0.750	190.500
7/8	0.875	222.250
1	1.000	254.000
1 1/8	1.125	285.750
1 1/4	1.250	317.500
1 3/8	1.375	349.250
1 1/2	1.500	381.000
1 5/8	1.625	412.750
1 3/4	1.750	444.500
1 7/8	1.875	476.250
2	2.000	508.000
2 1/8	2.125	539.750
2 1/4	2.250	571.500
2 3/8	2.375	603.250
2 1/2	2.500	635.000
2 5/8	2.625	666.750
2 3/4	2.750	698.500
2 7/8	2.875	730.250
3	3.000	762.000
3 1/8	3.125	793.750
3 1/4	3.250	825.500
3 3/8	3.375	857.250
3 1/2	3.500	889.000
3 5/8	3.625	920.750
3 3/4	3.750	952.500
3 7/8	3.875	984.250
4	4.000	1016.000
4 1/8	4.125	1047.750
4 1/4	4.250	1079.500
4 3/8	4.375	1111.250
4 1/2	4.500	1143.000
4 5/8	4.625	1174.750
4 3/4	4.750	1206.500
4 7/8	4.875	1238.250
5	5.000	1270.000
5 1/8	5.125	1301.750
5 1/4	5.250	1333.500
5 3/8	5.375	1365.250
5 1/2	5.500	1397.000
5 5/8	5.625	1428.750
5 3/4	5.750	1460.500
5 7/8	5.875	1492.250
6	6.000	1524.000
6 1/8	6.125	1555.750
6 1/4	6.250	1587.500
6 3/8	6.375	1619.250
6 1/2	6.500	1651.000
6 5/8	6.625	1682.750
6 3/4	6.750	1714.500
6 7/8	6.875	1746.250
7	7.000	1778.000
7 1/8	7.125	1809.750
7 1/4	7.250	1841.500
7 3/8	7.375	1873.250
7 1/2	7.500	1905.000
7 5/8	7.625	1936.750
7 3/4	7.750	1968.500
7 7/8	7.875	2000.250
8	8.000	2032.000
8 1/8	8.125	2063.750
8 1/4	8.250	2095.500
8 3/8	8.375	2127.250
8 1/2	8.500	2159.000
8 5/8	8.625	2190.750
8 3/4	8.750	2222.500
8 7/8	8.875	2254.250
9	9.000	2286.000
9 1/8	9.125	2317.750
9 1/4	9.250	2349.500
9 3/8	9.375	2381.250
9 1/2	9.500	2413.000
9 5/8	9.625	2444.750
9 3/4	9.750	2476.500
9 7/8	9.875	2508.250
10	10.000	2540.000
10 1/8	10.125	2571.750
10 1/4	10.250	2603.500
10 3/8	10.375	2635.250
10 1/2	10.500	2667.000
10 5/8	10.625	2698.750
10 3/4	10.750	2730.500
10 7/8	10.875	2762.250
11	11.000	2794.000
11 1/8	11.125	2825.750
11 1/4	11.250	2857.500
11 3/8	11.375	2889.250
11 1/2	11.500	2921.000
11 5/8	11.625	2952.750
11 3/4	11.750	2984.500
11 7/8	11.875	3016.250
12	12.000	3048.000
12 1/8	12.125	3079.750
12 1/4	12.250	3111.500
12 3/8	12.375	3143.250
12 1/2	12.500	3175.000
12 5/8	12.625	3206.750
12 3/4	12.750	3238.500
12 7/8	12.875	3270.250
13	13.000	3302.000
13 1/8	13.125	3333.750
13 1/4	13.250	3365.500
13 3/8	13.375	3397.250
13 1/2	13.500	3429.000
13 5/8	13.625	3460.750
13 3/4	13.750	3492.500
13 7/8	13.875	3524.250
14	14.000	3556.000
14 1/8	14.125	3587.750
14 1/4	14.250	3619.500
14 3/8	14.375	3651.250
14 1/2	14.500	3683.000
14 5/8	14.625	3714.750
14 3/4	14.750	3746.500
14 7/8	14.875	3778.250
15	15.000	3810.000
15 1/8	15.125	3841.750
15 1/4	15.250	3873.500
15 3/8	15.375	3905.250
15 1/2	15.500	3937.000
15 5/8	15.625	3968.750
15 3/4	15.750	4000.500
15 7/8	15.875	4032.250
16	16.000	4064.000
16 1/8	16.125	4095.750
16 1/4	16.250	4127.500
16 3/8	16.375	4159.250
16 1/2	16.500	4191.000
16 5/8	16.625	4222.750
16 3/4	16.750	4254.500
16 7/8	16.875	4286.250
17	17.000	4318.000
17 1/8	17.125	4349.750
17 1/4	17.250	4381.500
17 3/8	17.375	4413.250
17 1/2	17.500	4445.000
17 5/8	17.625	4476.750
17 3/4	17.750	4508.500
17 7/8	17.875	4540.250
18	18.000	4572.000
18 1/8	18.125	4603.750
18 1/4	18.250	4635.500
18 3/8	18.375	4667.250
18 1/2	18.500	4699.000
18 5/8	18.625	4730.750
18 3/4	18.750	4762.500
18 7/8	18.875	4794.250
19	19.000	4826.000
19 1/8	19.125	4857.750
19 1/4	19.250	4889.500
19 3/8	19.375	4921.250
19 1/2	19.500	4953.000
19 5/8	19.625	4984.750
19 3/4	19.750	5016.500
19 7/8	19.875	5048.250
20	20.000	5080.000
20 1/8	20.125	5111.750
20 1/4	20.250	5143.500
20 3/8	20.375	5175.250
20 1/2	20.500	5207.000
20 5/8	20.625	5238.750
20 3/4	20.750	5270.500
20 7/8	20.875	5302.250
21	21.000	5334.000
21 1/8	21.125	5365.750
21 1/4	21.250	5397.500
21 3/8	21.375	5429.250
21 1/2	21.500	5461.000
21 5/8	21.625	5492.750
21 3/4	21.750	5524.500
21 7/8	21.875	5556.250
22	22.000	5588.000
22 1/8	22.125	5619.750
22 1/4	22.250	5651.500
22 3/8	22.375	5683.250
22 1/2	22.500	5715.000
22 5/8	22.625	5746.750
22 3/4	22.750	5778.500
22 7/8	22.875	5810.250
23	23.000	5842.000
23 1/8	23.125	5873.750
23 1/4	23.250	5905.500
23 3/8	23.375	5937.250
23 1/2	23.500	5969.000
23 5/8	23.625	6000.750
23 3/4	23.750	6032.500
23 7/8	23.875	6064.250
24	24.000	6096.000
24 1/8	24.125	6127.750
24 1/4	24.250	6159.500
24 3/8	24.375	6191.250
24 1/2	24.500	6223.000
24 5/8	24.625	6254.750
24 3/4	24.750	6286.500
24 7/8	24.875	6318.250
25	25.000	6350.000
25 1/8	25.125	6381.750
25 1/4	25.250	6413.500
25 3/8	25.375	6445.250
25 1/2	25.500	6477.000
25 5/8	25.625	6508.750
25 3/4	25.750	6540.500
25 7/8	25.875	6572.250
26	26.000	6604.000
26 1/8	26.125	6635.750
26 1/4	26.250	6667.500
26 3/8	26.375	6699.250
26 1/2	26.500	6731.000
26 5/8	26.625	6762.750
26 3/4	26.750	6794.500
26 7/8	26.875	6826.250
27	27.000	6858.000
27 1/8	27.125	6889.750
27 1/4	27.250	6921.500
27 3/8	27.375	6953.250
27 1/2	27.500	6985.000
27 5/8	27.625	7016.750
27 3/4	27.750	7048.500
27 7/8	27.875	7080.250
28	28.000	7112.000
28 1/8	28.125	7143.750
28 1/4	28.250	7175.500
28 3/8	28.375	7207.250
28 1/2	28.500	7239.000
28 5/8	28.625	7270.750
28 3/4	28.750	7302.500
28 7/8	28.875	7334.250
29	29.000	7366.000
29 1/8	29.125	7397.750
29 1/4	29.250	7429.500
29 3/8	29.375	7461.250
29 1/2	29.500	7493.000
29 5/8	29.625	7524.750
29 3/4	29.750	7556.500
29 7/8	29.875	7588.250
30	30.000	7620.000
30 1/8	30.125	7651.750
30 1/4	30.250	7683.500
30 3/8	30.375	7715.250
30 1/2	30.500	7747.000
30 5/8	30.625	7778.750
30 3/4	30.750	7810.500
30 7/8	30.875	7842.250
31	31.000	7874.000
31 1/8	31.125	7905.750
31 1/4	31.250	7937.500
31 3/8	31.375	7969.250
31 1/2	31.500	8001.000
31 5/8	31.625	8032.750
31 3/4	31.750	8064.500
31 7/8	31.875	8096.250
32	32.000	8128.000
32 1/8	32.125	8159.750
32 1/4	32.250	8191.500
32 3/8	32.375	8223.250
32 1/2	32.500	8255.000
32 5/8	32.625	8286.750
32 3/4	32.750	8318.500
32 7/8	32.875	8350.250
33	33.000	8382.000
33 1/8	33.125	8413.750
33 1/4	33.250	8445.500
33 3/8	33.375	8477.250
33 1/2	33.500	8509.000
33 5/8	33.625	8540.750
33 3/4	33.750	8572.500
33 7/8	33.875	8604.250
34	34.000	8636.000
34 1/8	34.125	8667.750
34 1/4	34.250	8699.500
34 3/8	34.375	8731.250
34 1/2	34.500	8763.000
34 5/8	34.625	8794.750
34 3/4	34.750	8826.500
34 7/8	34.875	8858.250
35	35.000	8890.000
35 1/8	35.125	8921.750
35 1/4	35.250	8953.500
35 3/8	35.375	8985.250
35 1/2	35.500	9017.000
35 5/8	35.625	9048.750
35 3/4	35.750	9080.500
35 7/8	35.875	9112.250
36	36.000	9144.000
36 1/8	36.125	9175.750
36 1/4	36.250	9207.500
36 3/8	36.375	9239.250
36 1/2	36.500	9271.000
36 5/8	36.625	9302.750
36 3/4	36.750	9334.500
36 7/8	36.875	9366.250
37	37.000	9398.000
37 1/8	37.125	9429.750
37 1/4	37.250	9461.500
37 3/8	37.375	9493.250
37 1/2	37.500	9525.000
37 5/8	37.625	9556.750
37 3/4	37.750	9588.500
37 7/8	37.875	9620.250
38	38.000	9652.000
38 1/8	38.125	9683.750
38 1/4	38.250	9715.500
38 3/8	38.375	97