

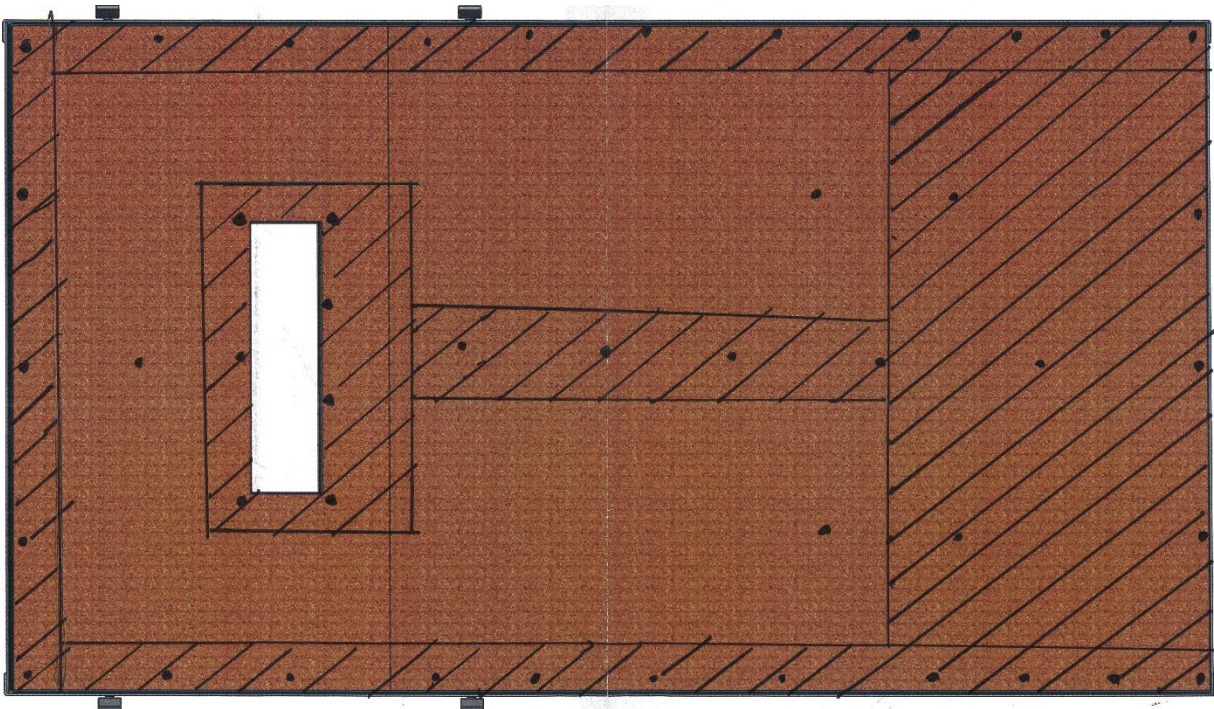

E-0011-S004 (Replacement Synthetic Turf, Green Colored Synthetic Turf with Thatch Layer).

E-0011-S008 (Replacement Synthetic Turf, Red Clay Colored Synthetic Turf with Thatch Layer).

1. Remove infill by use of shop vac. Recycle for later use.
2. Locate and remove screws as designate per diagram (dots designate approximate screw head locations).



3. Pull worn carpet from the unit.
4. Place new carpet onto unit.
5. Screw carpet with fresh hardware supplied with the replacement kit. Apply screws in the same general vicinity so future replacements can reuse the below diagram for reference.
6. Apply infill.
7. Replacement complete.

REPLACEMENT PARTS

Contact Sportsfield Specialties Customer Service at 1-888-975-3343 for replacement hardware.



Sportsfield Specialties, Inc.

P.O. Box 231

41155 State Highway 10

Delhi, N.Y. 13753

Phone: 888-975-3343

Fax: 607-746-8911

www.sportsfieldspecialties.com