

Synthetic Turf Provided By and Installed By Others

Includes Replaceable

Patent Pending

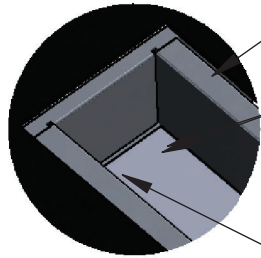

Synthetic Infill Turf Attachment Ledge
Removable Pitching Rubber Tray With 3/8" Threaded Stud And Bolt For Pitching Rubber Height Adjustment
Drainage Pipe

DETAIL A

(Pitching Rubber Removed For Clarity)

Stake Holes For Anchoring (Rebar By Others)

Notched Cutouts For Rebar Bracing (Rebar By Others)

2"x4" Synthetic Turf Nailers (Material And Install By Others)

6"W x 24"L Four-Sided Pitching Rubber

1/4" Roll Out Rubber Underlayment

A

Three Piece Welded Aluminum Frame With Bolted Connections

Synthetic Turf Replacement Size is 58"W x 152"L

Available As A Single, Double Or Triple Bullpen Mound Configuration

Knock Out Perforations For Concrete Flow In Multi-Mound Systems

Front And Rear Spacing Brackets For Multi-Mound Systems, Adjustable From 5' to 10' (C To C Of Pitching Rubbers)

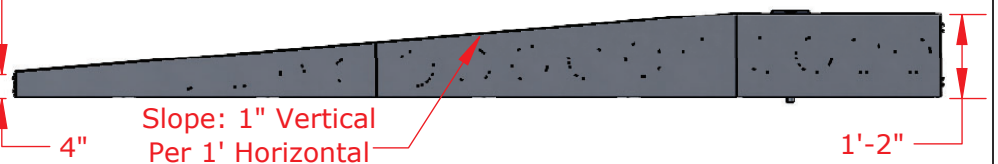
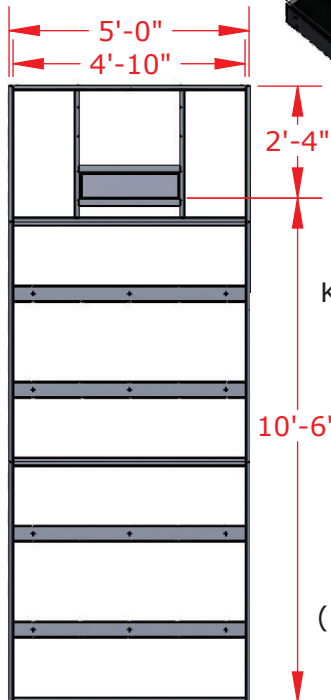

Part No.	Description
PMFSBPS	Single Mound Forming System
PMFSBPD	Double Mound Forming System
PMFSBPT	Triple Mound Forming System

PROPRIETARY AND CONFIDENTIAL

THE INFORMATION CONTAINED IN THIS DRAWING IS THE SOLE PROPERTY OF SPORTSFIELD SPECIALTIES INC. ANY REPRODUCTION IN PART OR AS A WHOLE WITHOUT THE WRITTEN PERMISSION OF SPORTSFIELD SPECIALTIES INC. IS PROHIBITED.

Bullpen Pitching Mound Forming System

Not To Scale

Sportsfield Specialties Inc 104595.1-06252024